

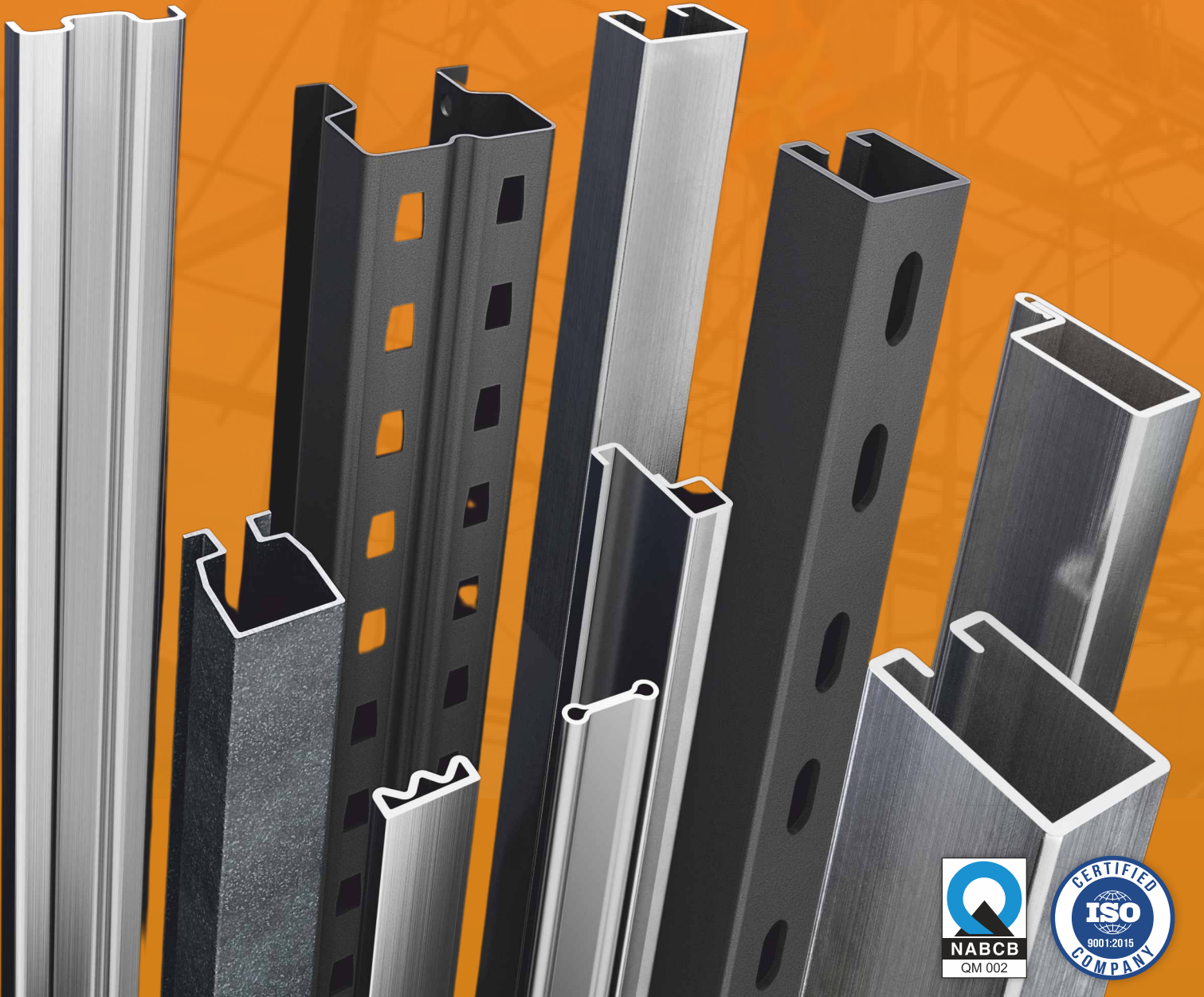

DIVY ROLLFORM LTD.

Cold Rollformed Metal Sections & Profiles





About us

Divy Rollform Limited stands at the forefront of the cold roll-forming industry, having a cutting-edge manufacturing facility strategically located near Ahmedabad, spanning an impressive 10000 sq. meters across two facilities. With over two decades of experience, we have established ourselves as pioneers in the production of high-quality cold roll-formed sections and profiles, excelling in materials such as mild steel, stainless steel and coated materials. Our operational capacity of 6000 TPY, coupled with a rich industrial experience, allows us to offer an extensive range of standard profiles and custom-designed sections tailored to meet the unique needs of our diverse customer base.

As a family-run business rooted in Indian values and guided by global vision, Divy Rollform Limited takes pride in its extensive and satisfied customer base, both domestically and internationally. Committed to manufacturing excellence, we have earned the trust of customers across the country through adherence to stringent quality standards and ISO 9001:2015 certification. This international outreach not only reflects our dedication to global standards but also underscores our ability to seamlessly cater to diverse customer needs on a global scale. With the base of highly qualified and technically sound directors and self-motivated team members, the company is on its uninterrupted journey of progress and excellence.

Why Divy Rollform Ltd



Pioneering Expertise

We are one of the founding companies in India, to start production of profiles.



In-House Excellence

Integrated slitting facility for traceable heat numbers, guaranteeing quality and timely delivery. Moreover, we also have In-House Punching and Fabrication facility.



Premium Raw Materials

Exclusive sourcing from JSW/AMNS/TATA/SAIL, backed by in-house quality control.



Consistent Quality

Stringent quality control measures throughout the manufacturing process for consistent excellence.



Timely Delivery

Streamlined processes for prompt, timely product delivery.



Tailored Solutions

Committed to customizing Profiles and Sections to perfectly meet your unique requirements.

Strut Channel



Specifications

Material	Mild Steel, Pre-galvanised, SS-304, SS-316
Sizes Available	41 X 21, 41 X 41, 41 X 61, 41 X 81
Thickness	1.2mm To 2.5mm
Finish	Duly Powder Coated, Hot Dip Galvanized
Type	Solid & Slotted

Application

- Industrial Plumbing
- Heating and sanitary supply piping
- Firefighting systems
- Residential and commercial piping
- Electrical installations like cable trays, data lines etc.
- Solar modules installations
- Fabrication
- HVAC-piping and ducting installations
- Automation systems
- Assembly lines and transfer lines
- Conveyors
- Structural framing
- Building and construction
- Storage

Back to Back

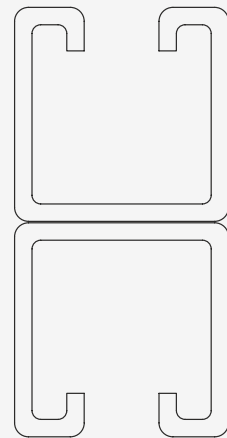

41X21

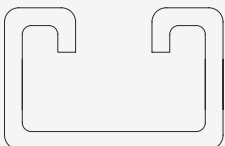

41x41

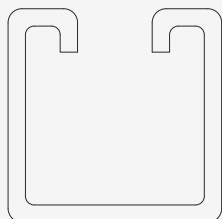

41x61

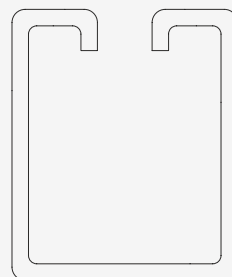

41x81

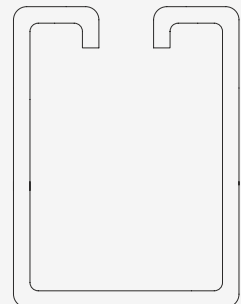

Z Purlin And Z Profile

DESCRIPTION	MAXIMUM	MINIMUM
W	350	100
H1-H2	80	40
L1-L2	30	10
T	6	1

DEGREE 45°, 60°, 90°

APPLICATION

Shed construction, Roofing and Cladding

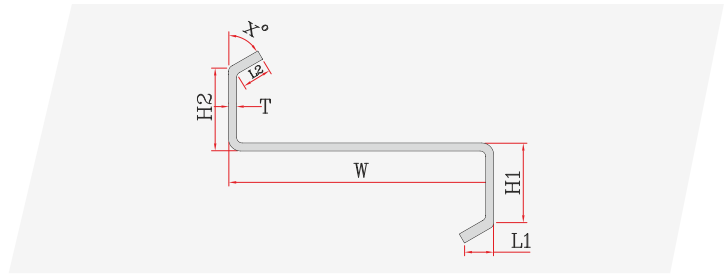

Interlocking Beam (ILB)

DESCRIPTION	MAXIMUM	MINIMUM
W	150	80
H1-H2	50	44.5
L1-L2	15	10
T	2	1

APPLICATION

Construction, as column, as beam

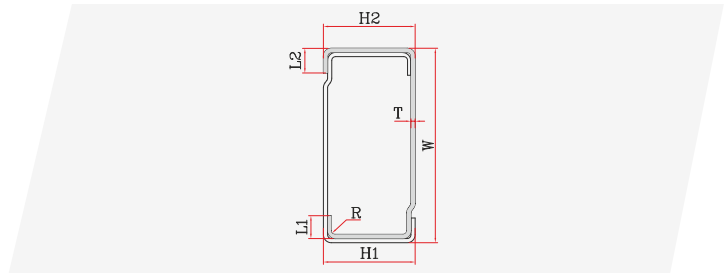

Upright Section

DESCRIPTION	MAXIMUM	MINIMUM
W	450	100
H1-H2	80	40
L1-L2	30	15
T	4	1

APPLICATION

Industrial Storage & racking system

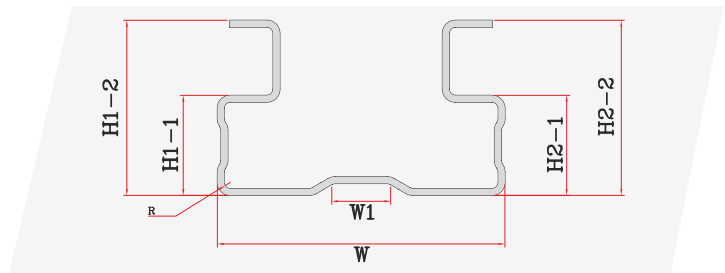

Terminal Channel

DESCRIPTION	MAXIMUM	MINIMUM
W	32	32
H1-H2	15	9
L1-L2	10	5
T	2	1.5

APPLICATION

Pannel board instrument fitting, Terminal fitting

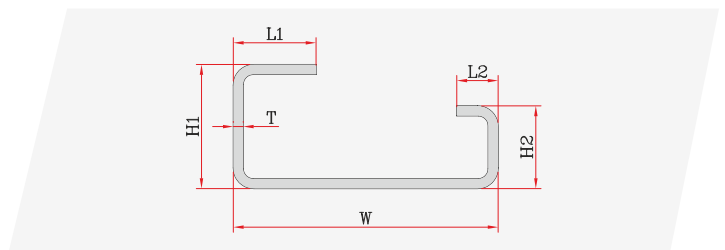

MCB Channel

DESCRIPTION	SIZE
W	25
H1-H2	7.5
L1-L2	6
T	1

APPLICATION

Pannel board instrument fitting, MCB fitting

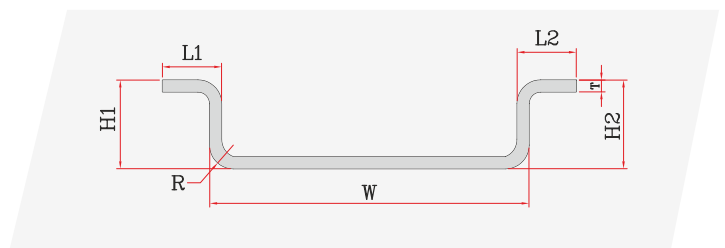

Open Square Pipe

DESCRIPTION	MAXIMUM	MINIMUM
W	50	12
L1-L2	30	5
T	8	1

APPLICATION

Process industry, conveyors, furniture

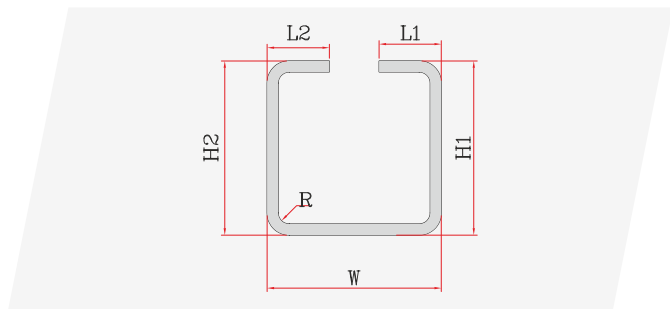

C Track

DESCRIPTION	MAXIMUM	MINIMUM
W	450	100
H1-H2	80	40
L1-L2	30	15
T	4	1

APPLICATION

In tracks of material handling system

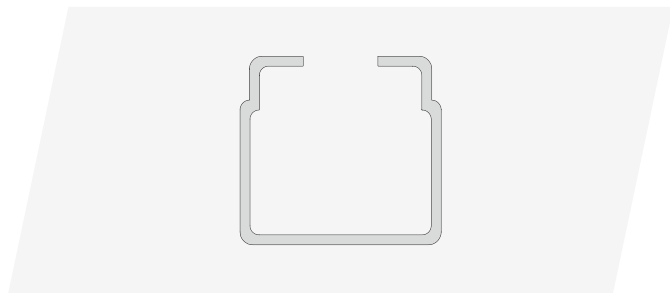

Custom Made Sections



Lip Channel

DESCRIPTION	MAXIMUM	MINIMUM
W	450	12
H1-H2	100	20
L1-L2	30	5
T	6	1

APPLICATION

Shed Construction, Electrical,
Architectural Aapley Support/ Storage System,
Conveyors, Pollution Control equ., Solar Structure

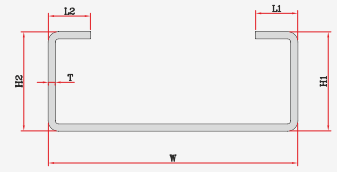

C Channel

DESCRIPTION	MAXIMUM	MINIMUM
W	525	10
H1-H2	100	10
T	8	1

APPLICATION

Chassis Of Automobiles,
Construction Ind., Scaffolding, Textile Ind.,
Material Handling Storage System, Conveyors

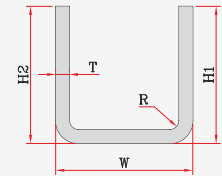

Top Hat Section

DESCRIPTION	MAXIMUM	MINIMUM
W	150	15
H1-H2	100	5
L1-L2	30	5
T	3	1

APPLICATION

Truss Member,
Automobile Body,
Fencing,
Solar Structure

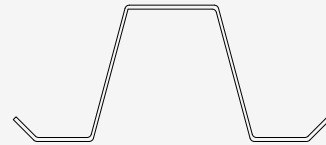

Sigma Sections

DESCRIPTION	MAXIMUM	MINIMUM
W	300	100
H1-H2	80	40
L1-L2	30	15
T	4	1

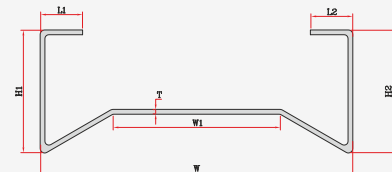

Step Section

DESCRIPTION	MAXIMUM	MINIMUM
W1	65	30
W2	75	25
H1	20	15
H2	27	27
T	3	2

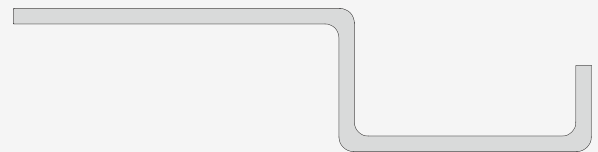

Services

Slitting Facility

COIL WIDTH	1250/1500
THICKNESS	1 MM - 6 MM
MAX COIL WEIGHT	35 MT
MATERIAL	MS, SS, GI

Advantages of Cold Rollforming



Extremely Rapid
manufacturing
process for
uncomparable
volumes



Versatility in
thickness and
length



Adaptable for
various profiles and
configurations



Process can easily
incorporate in-line
punching and other
modifications for
tailored solutions



Cold rollforming
ensures precise and
consistent shapes,
meeting tight tolerances
& straightness



Cold forming
enhances material
strength, providing
durable solutions



Process suitable for
pre-coated material
eliminating need for
secondary coating



Efficient process with
minimal material waste



Smooth and
uniform surface



Lesser emissions compared
to Hot Rollforming

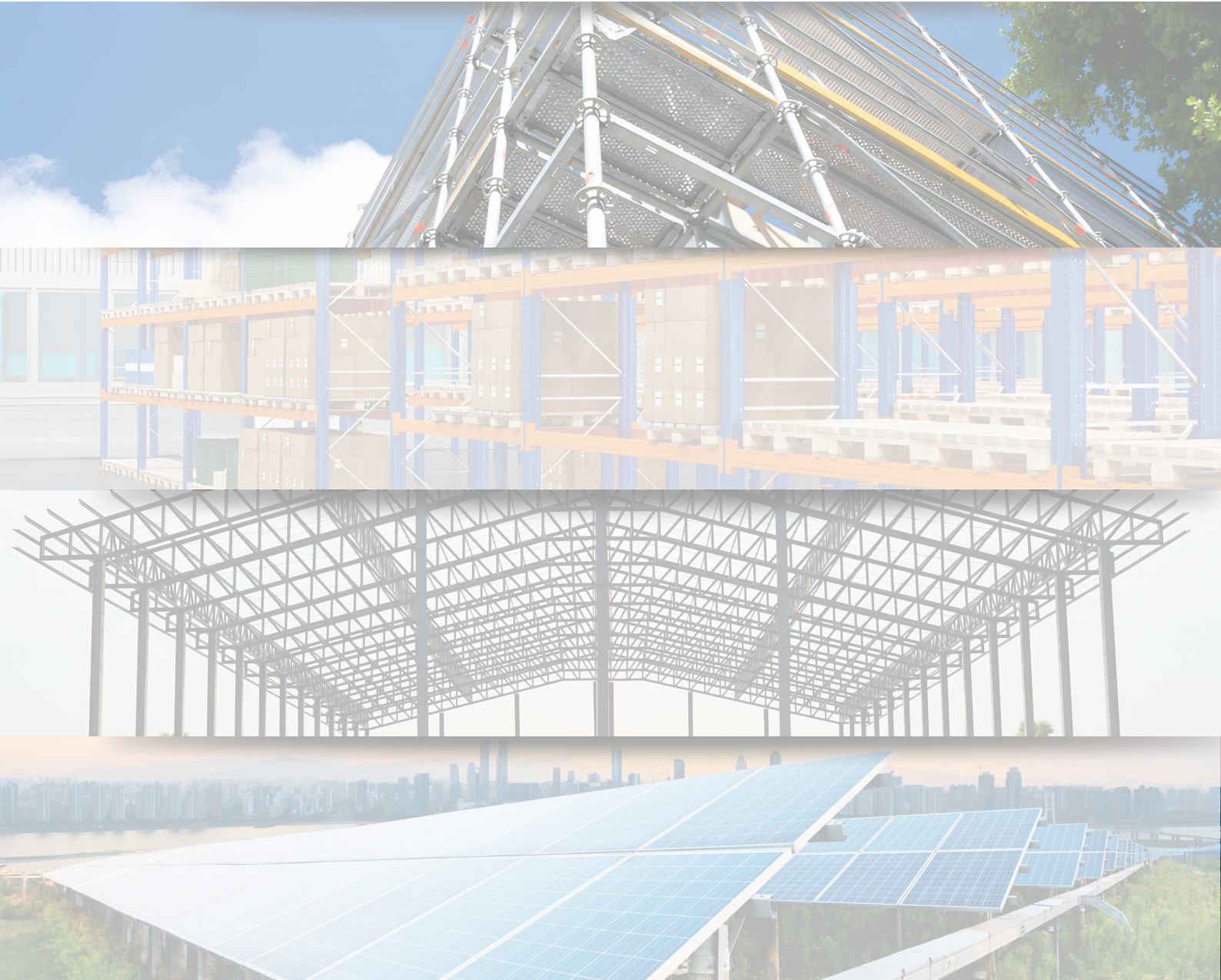

GET IN TOUCH



Divy Rollform Ltd.



UNIT-1:

Block No.91, Opp Elite School, Vavdi,
Kheda-Dholka Road Dist: Kheda, Gujarat -387560, INDIA



+91-9429100411, +91-9409104144



info@divyrollform.com, divy.shah@divyrollform.com



www.divyrollform.com



WEBSITE



E-BROCHURE



UNIT-2:

Block No. 823,882, Navagam, Behind G.C.S-1 ONGC,
Dandi Heritage marg (NH223), Dist: Kheda, Gujarat